

WYLER AG
Im Hoelderli 13
8405 Winterthur
Switzerland

Tel. +41 52 233 66 66 E-Mail: wyl@wyl.com www.wyl.com

Outside Switzerland: contact our representatives
www.wyl.com/en/contact/representatives/

Thank you for choosing WYLER!

Read this quick reference before start working with the **wylerLEVEL Frame / wylerCLINO Frame**.
Please note the safety instructions.

Brand and Type

Brand: **wylerLEVEL Frame / wylerCLINO Frame**

Types: wylerLEVEL Frame	Product no.	001-160-2211-52AA, ff	001-200-2211-52AA, ff
		001-160-2431-52AA, ff	001-200-2431-52AA, ff
wylerCLINO Frame	Product no.	002-160-2211-5160, (-5260, -5360) ff	
		002-160-2431-5160, (-5260, -5360) ff	

Warning! The following sign is used in this Quick Reference:
This is intended to indicate special dangers



Safety instructions

The **wylerLEVEL Frame / wylerCLINO Frame** complies with the applicable directives and standards, see:

- This Quick Reference
- The type label on the back of the device
- The manual at www.wyl.com
- The CE Declaration of Conformity at www.wyl.com

Intended Use

- The **wylerLEVEL Frame / wylerCLINO Frame** is designed exclusively for measuring inclination angles.
- **Attention!:** There is no other use allowed!

Not intended use

- The device does not serve as a support in vices! The precise housing can deform.
- Do not immerse underwater! Since the device may suffer a short circuit inside.
- Do not use as a hammer! The damaged measuring surfaces are then no more precise.
- Do not throw the device! The housing can cause serious injury.

WARNING

- Do not use this device near sources of strong electromagnetic energy Radiation (e.g., unshielded radio frequency source) because they can interfere with operation.
- Use only high quality, leak proof batteries.
- For longer storage times, please remove the batteries because of the risk of leakage. The acid can damage the electronics in the device.
- Always close the battery cover on the device carefully, but not with force!

Technical datas, Mass, Weight, Protection, Operation, Storage

Measuring range:		Resolution (tested unit)	(alternative unit)
wylerLEVEL Frame: ± 20 mm/m		0,001 mm/m	(0,2 arcsec)
wylerCLINO Frame 10°: ± 10°		2 arcsec	(0.01 mm/m)
wylerCLINO Frame 60°: ± 60°		5 arcsec	(0.02 mm/m)
Dimension L x H x B:	160 x 160 x 40 mm	Wight device:	Cast: 3450g Alu: 1600 g
	200 x 200 x 40 mm		5450g -----
Storage:	In case: -30° bis +70° C	Operation temperature:	0° bis 40° C

Device, Batteries (case: accessories see www.wyl.com)

- ① **Case** for storage, transport and shipping for repair
- ② **wylerLEVELFrame / wylerCLINO Frame,**
- ③ **2 Batteries Type C, 1.5 V**
- ④ **Quick Reference** (Manual see www.wyl.com)

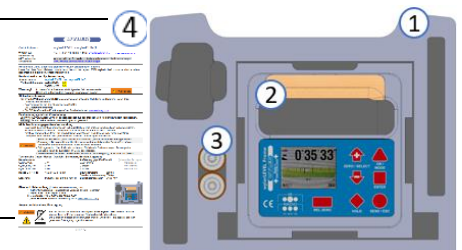

Decommissioning, disposal

WARNING



When decommissioning the **wylerLEVEL Frame / wylerCLINO Frame**, follow the local regulations for disposal of electronic waste.
The batteries must be removed from the device and both parts must be disposed of properly.

Overview

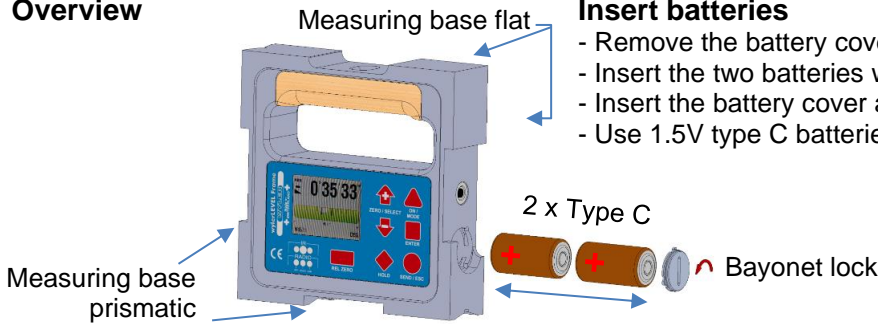

Insert batteries

- Remove the battery cover
- Insert the two batteries with the plus pool in front.
- Insert the battery cover and turn it.
- Use 1.5V type C batteries or 1.2V rechargeable batteries.

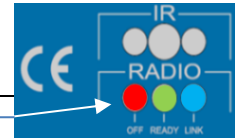

Switch on: Press the button 1 ON/MODE until the lower 3 LEDs flash.
Switch off: Press the button 1 ON/MODE until the screen goes blank.

Keyboard, screen overview

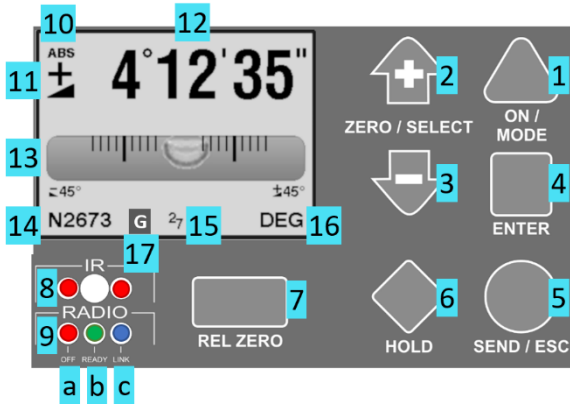

- 1 ON/MODE: ON/OFF or Selection in the menu
- 2 Next selection +, or graphical scales zoom +
- 3 Next selection -, or graphical scales zoom -
- 4 Accept selection or save input
- 5 Unfreeze or Cancellation of the menu selection
- 6 Freeze value
- 7 Use the current measured value as "relative zero"
- 8a+c flashing red: Detects the IR signal of the wylerTRIGGER *
- 8b IR receiver
- 9a lights up red: radio off or defective
- 9b lights up green: radio OK
- 9c Lights up blue: radio active and connected
- 10 ABS: measured value absolute, REL: measured value based on REL ZERO (7)
- 11 Incline triangle rising and falling as well as plus + / minus - signs according to the incline
- 12 Measured value
- 13 Graphical sign of the measured value (if selected in the menu)
- 14 Serial number
- 15 Battery voltage (3V down to a minimum of 2.2V -> battery change)
- 16 Unit
- 17 G = Gravitational constant was adjusted

* option

Operating concept

E.g. → Reversal measurement:
for absolute measured values

Relative ZERO:

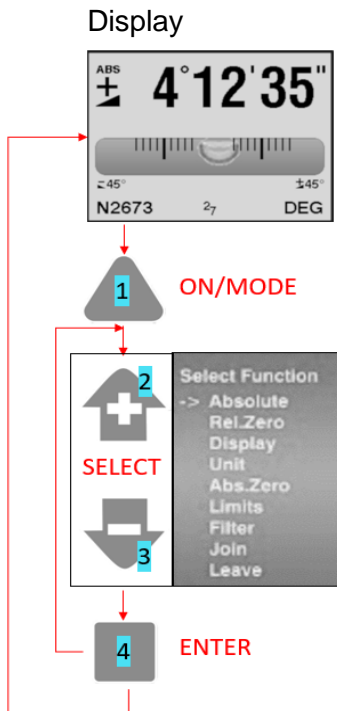

Key sequence:

- 1 ON/MODE
- 3 SELECT - «Abs.Zero»
- 4 Enter Image «Position device»
- 4 ENTER Image «measurement in progress»
- 4 ENTER Image «Turn device 180 °»
- 4 ENTER Image «measurement in progress»

Display: Measurement, ABS

Then the display shows the measured value and top left:



Key sequence:

Direct key 7:
Triggers the relative zeroing
alternatively:

- 1 ON/MODE
- 3 SELECT - «Rel.Zero»
- 4 Enter Image «Position device»
- 4 ENTER Image «measurement in progress»

Then the display shows the measured value and top left:



For more information please read the manual at www.wylerag.com